

INSTRUCTION MANUAL

Tire Sander SK-600072

SKYRC

Thank you for purchasing SkyRC Tire Sander, This Tire Sander can be powered by a 12V power supply, as well as powered directly from a 2S LiPo battery! The Tire Sander is a quick and easy way to remove the seam from the center of a new tire, without having to take 2-3 laps around the track.

FEATURES

- Rubber tire sander for touring class
- Powerful high torque DC motor with dual metal bearings
- Adjustable RPM of motor
- 8 LEDs indicate tire running RPM
- Direction of running rotation can be changed
- Light-weight aluminum case
- Input reverse polarity protection

ILLUSTRATION

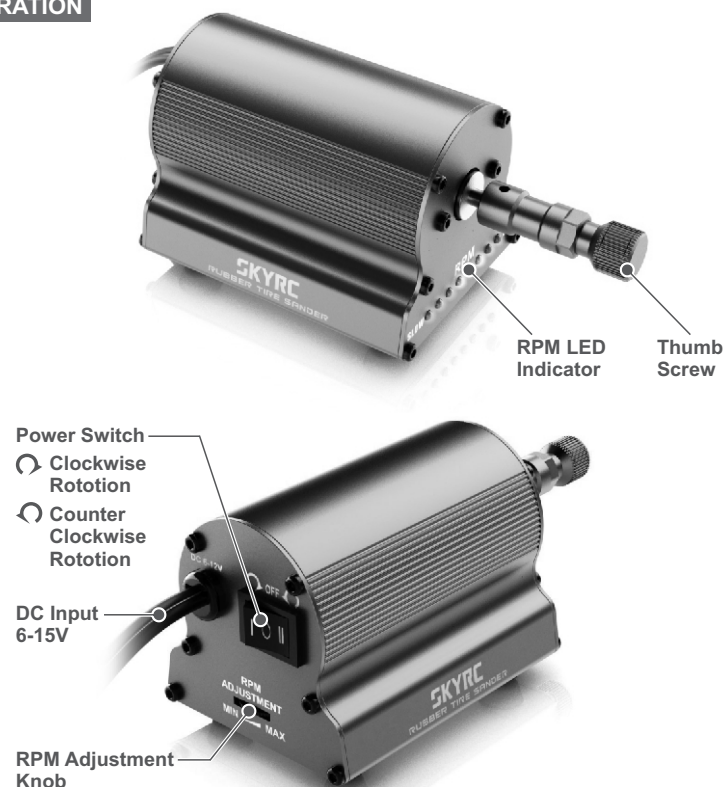

HOW TO OPERATE



1. Remove thumb screw



2. Put rubber tire to tire sander and tighten the thumb screw firmly



3. Connect tire sander to power supply or 2S LiPo battery

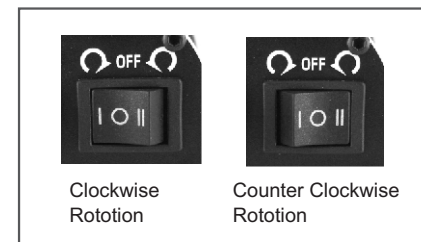

4. Change rotation direction



5. Adjust RPM knob if necessary



6. Ready

SPECIFICATIONS

- Input Voltage: DC 6V-15V
- Minimum Input Current: 10A
- Case Material: Aluminum
- Power Supply Cable: Silicon Cable with Banana Plug
- Dimension: 159x70x66mm
- Weight: 710g



Manufactured by
SKYRC TECHNOLOGY CO., LTD.
www.skyrc.com

7504-0450-01